

# One-Time Case Release Unit (Locker/Unlocker)

## Installation Instructions

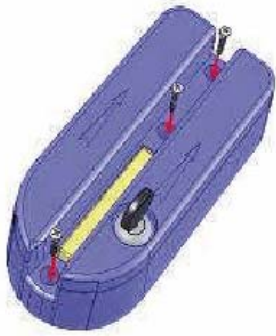

1. Fasten the unit into position with 3 screws provided

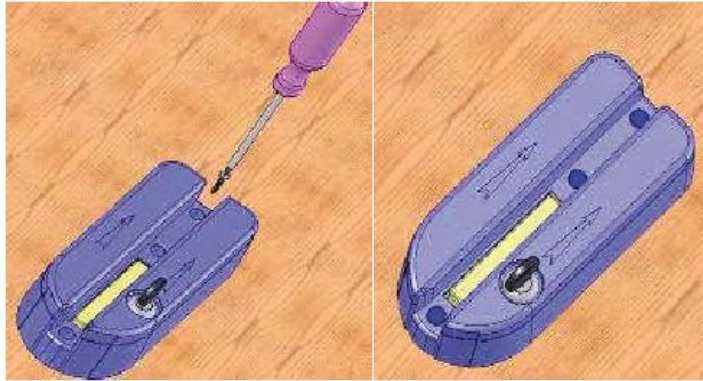

2. Mount unit permanently to counter.



3. Conceal screws with plastic caps provided.

- Horizontal surface mount is preferred. Vertical mounting is an option but not recommended.
- During installation, orient unit so unlocking is achieved by pulling the case TOWARD the user.
- Unit contains a high powered magnet - position with surroundings in mind.
- Avoid placing metal objects such as scissors, cutters etc near the unit.
- Keep the unit away from CRT monitors or other items affected by magnetic fields.

## Case Unlocking and Locking



1. Slide the One-Time case through the channel following directional arrows featured on top of the release unit. (The DVD front cover should face the side WITHOUT the key lock).

2. After sliding case through channel, always visually check to ensure case is unlocked before customer leaves.



RED lock indicates LOCKED



GREEN lock indicates UNLOCKED

3. When cases are returned, the One-Time case can be locked and returned to the shelf by :
- Sliding the case through the lock channel in the opposite direction of the directional arrows featured on the top of the unit. Case cover must face the side WITHOUT the key lock, or
  - Sliding the case through the lock channel in the same direction as the directional arrows with the case cover facing the side WITH the key lock.

## Unauthorised Use Prevention

The One-Time release unit features a channel block to avoid unauthorized usage when the checkout counter and/or unit are not in use.

**Note :** the unit is supplied with two keys that are numbered to match the serial number of the unit and are unique to each unit. Please ensure keys are matched to each unit and kept safe and secure.



Insert key in lock



Turn key to activate channel block