



ACADIA Table Top With Tech Storage

Assembly Instructions

AC/TT/BP/G/B



43" - 65"
55 lb (25kg)



SCREEN : 55 lb (25kg)
VIDEO BAR : 15 lb (7kg)
DEVICES : 2 x 9 lb (2 x 4kg)



SALAMANDER
DESIGNS



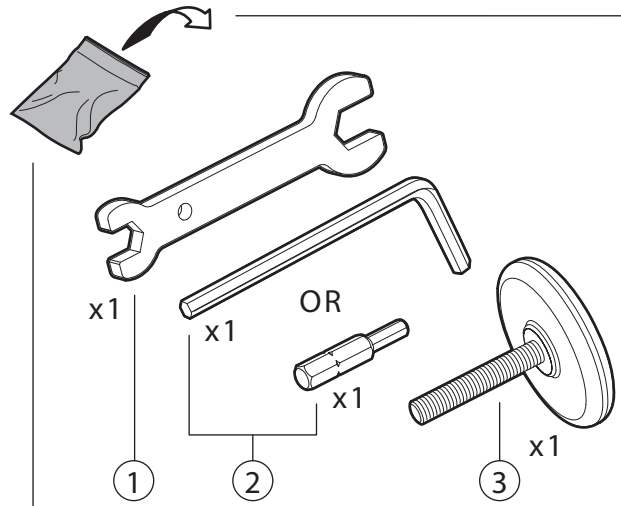

scale 1:1

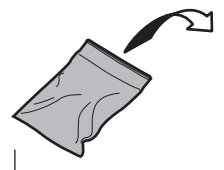
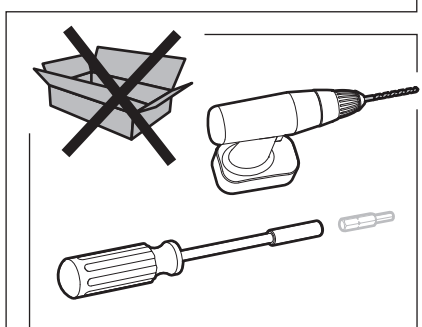
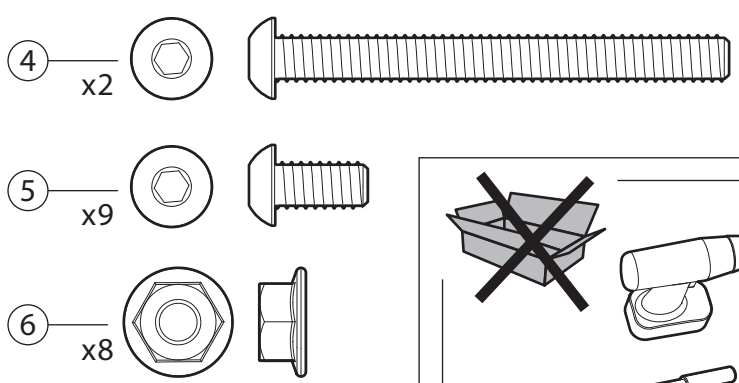

scale 1:1

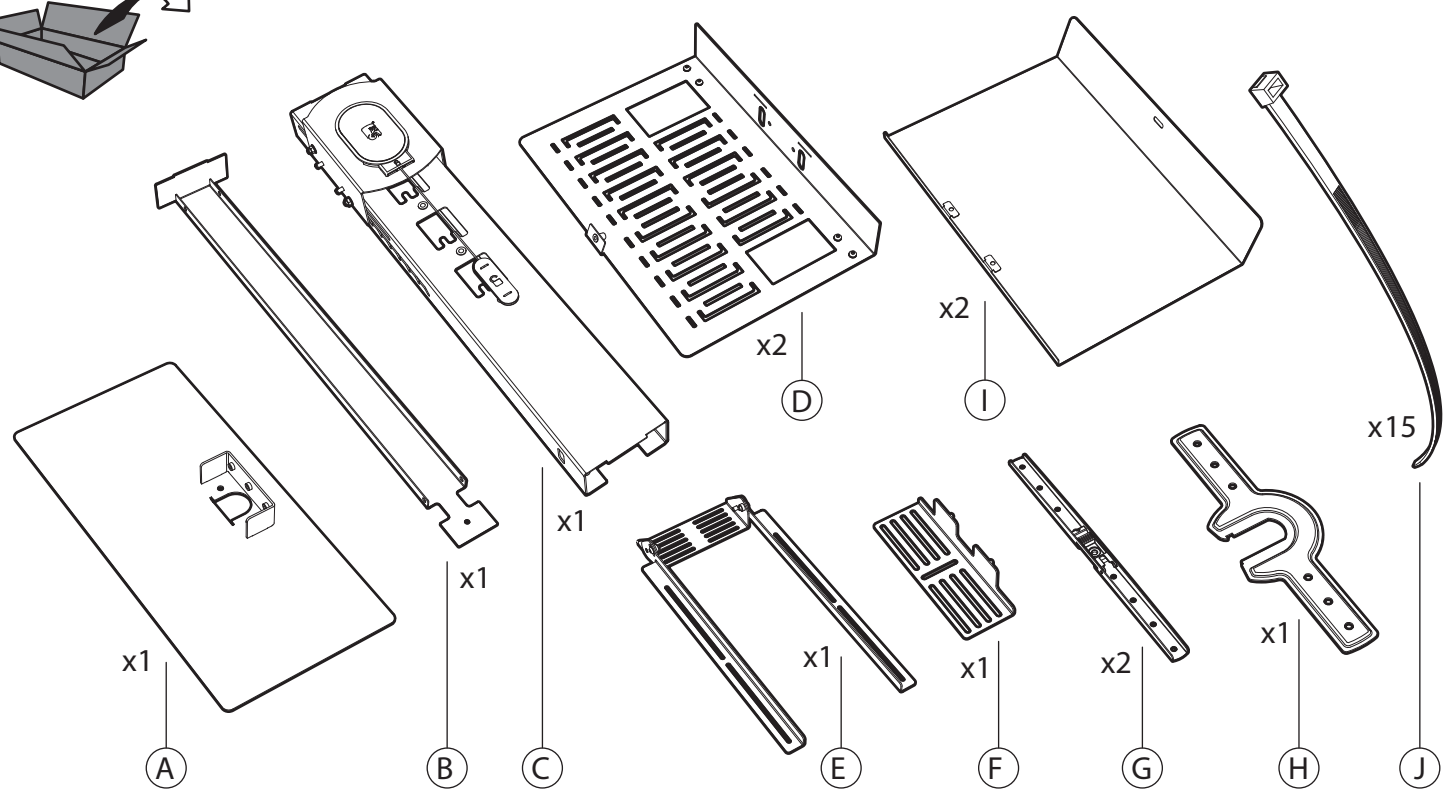
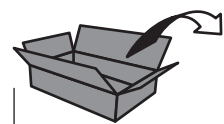
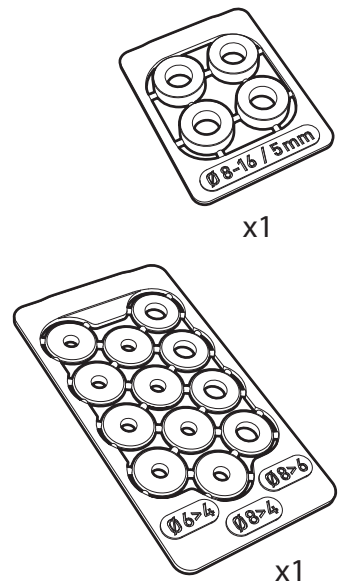
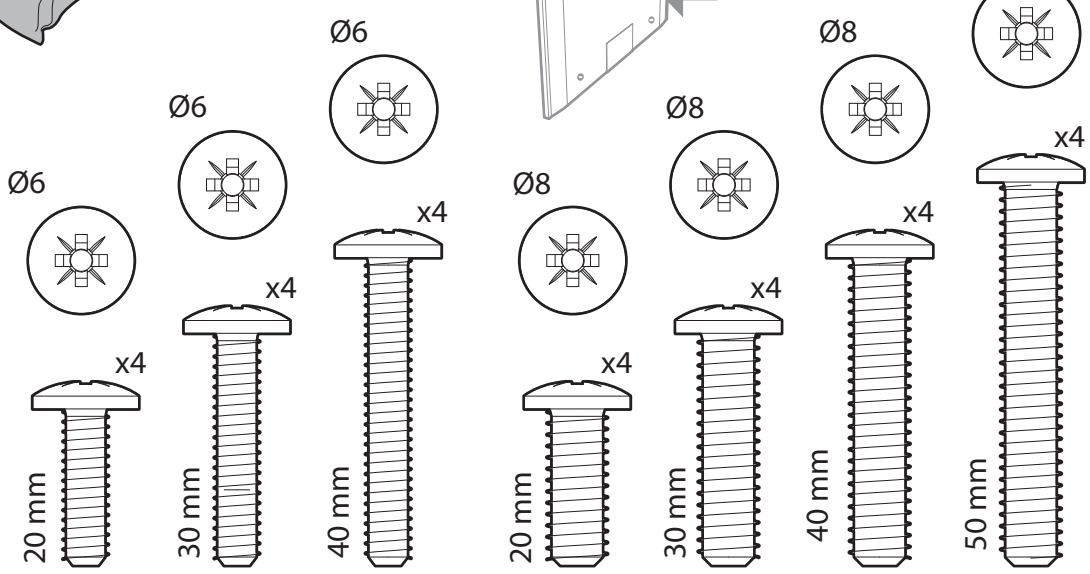
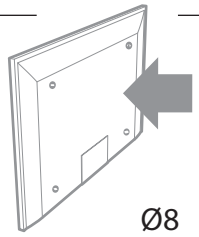

1 To provide additional security and stability

④ x 2 + ⑥ x 2 + ① + ②

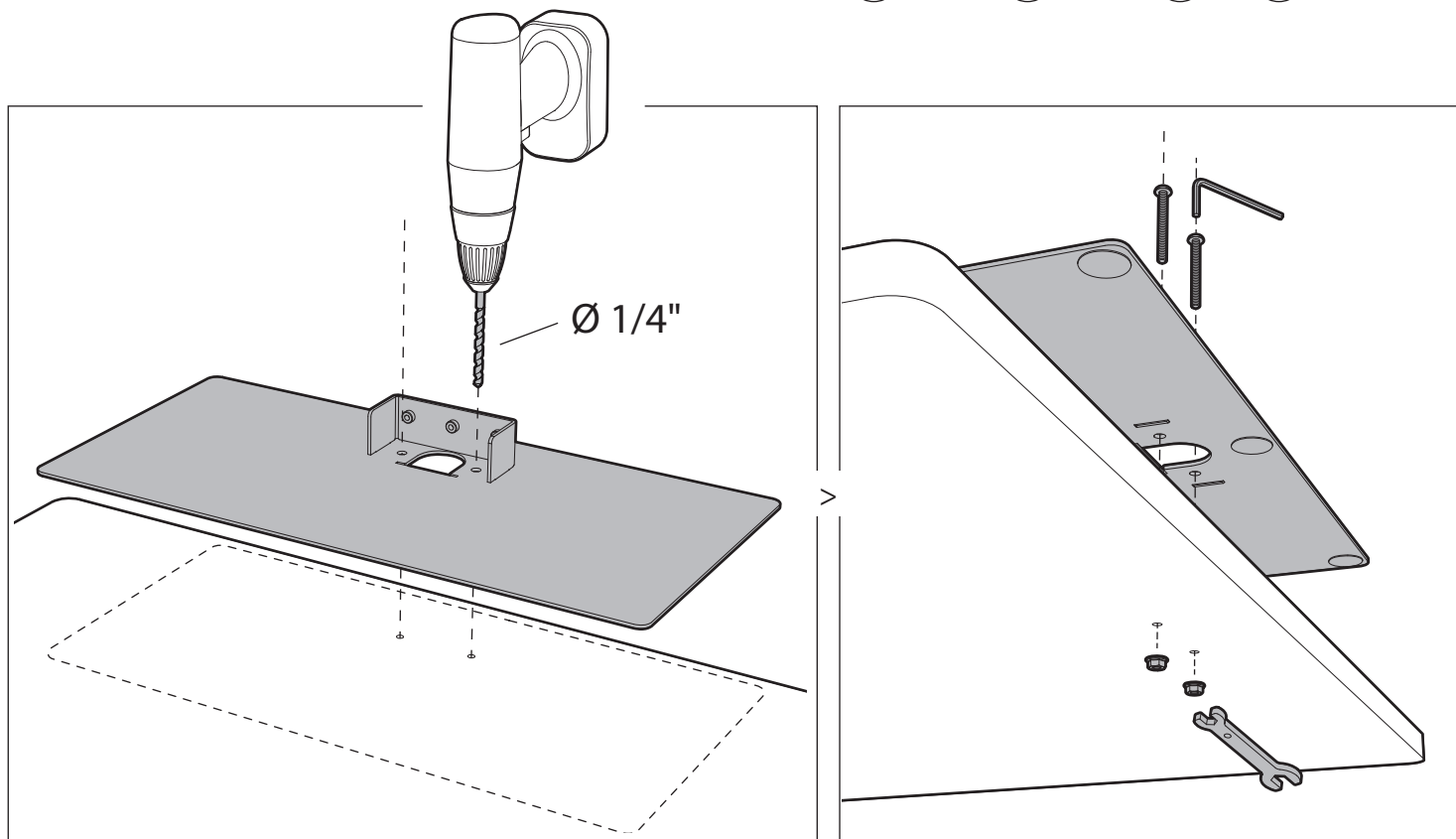

1 ALTERNATIVE

To provide additional security and stability
but without drilling the table

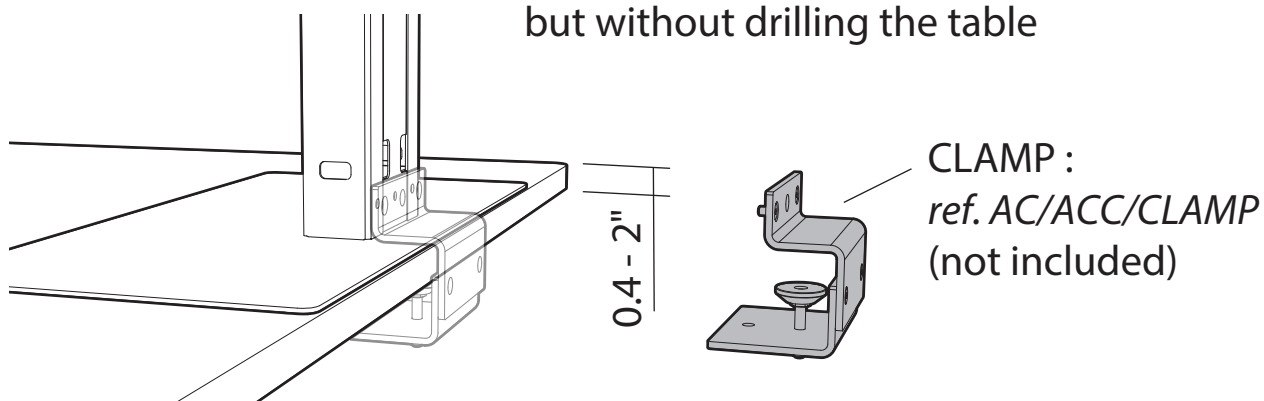

2 ⑤ x 2 + ②

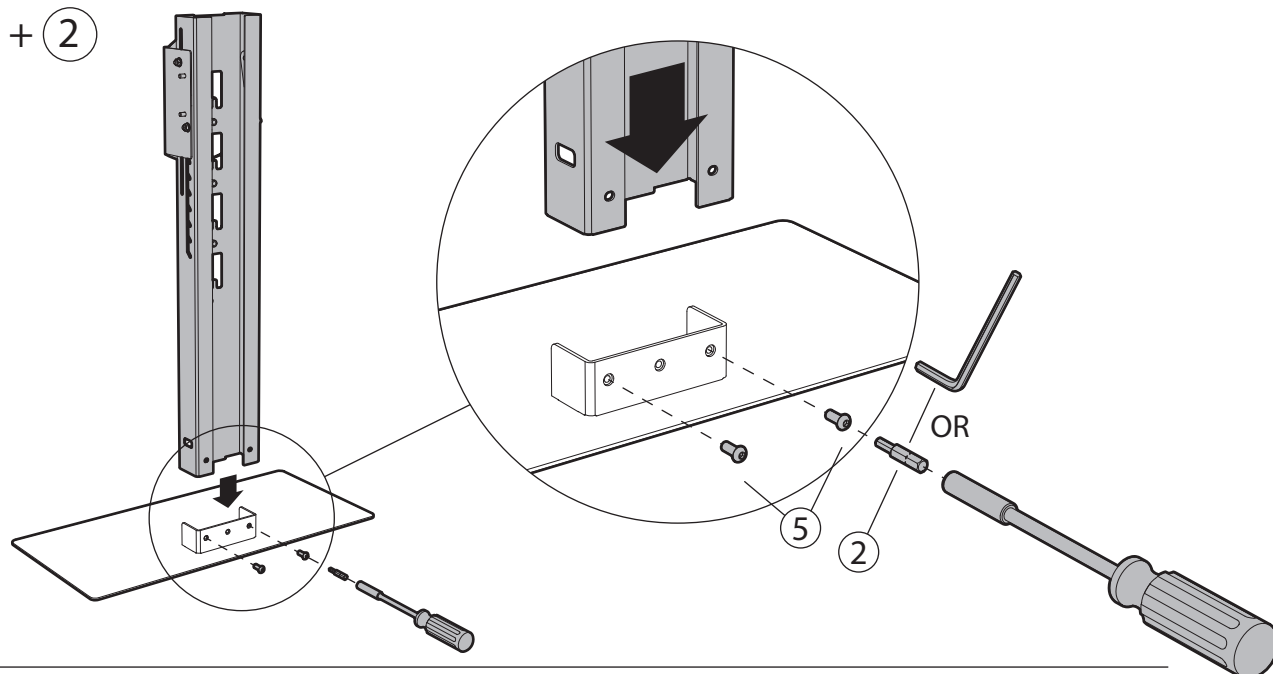

3

①

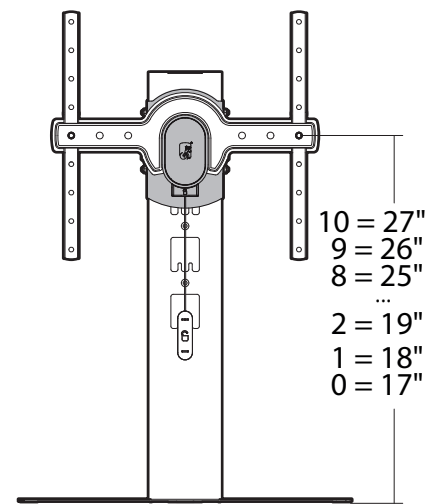
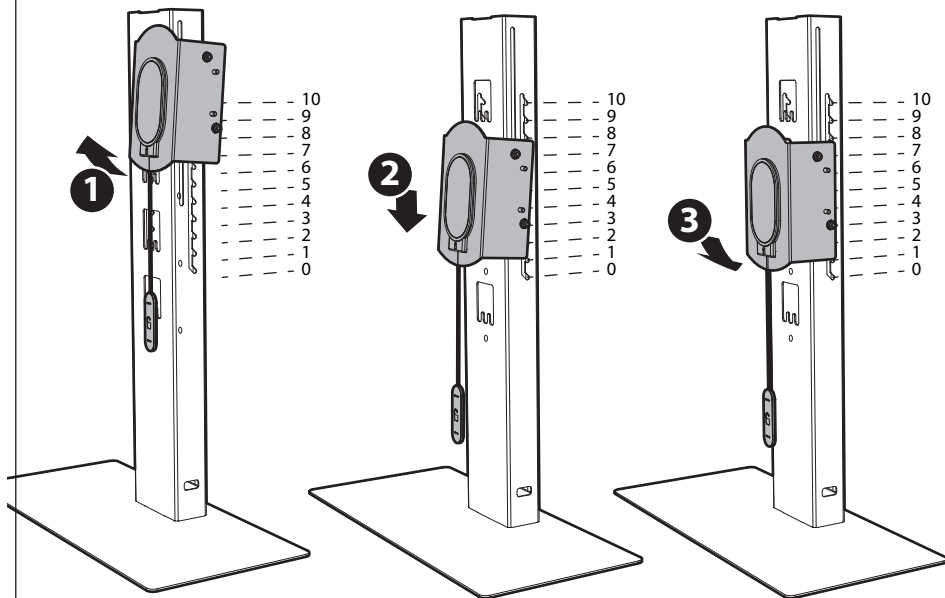

conversion chart

17" = 432 mm	21" = 533 mm	25" = 635 mm
18" = 457 mm	22" = 582 mm	26" = 660 mm
19" = 483 mm	23" = 584 mm	27" = 686 mm
20" = 508 mm	24" = 610 mm	

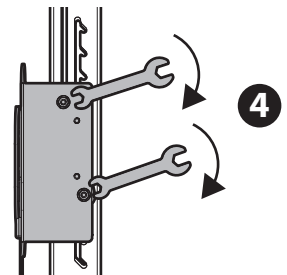

4

① + ① x2 + ① x4

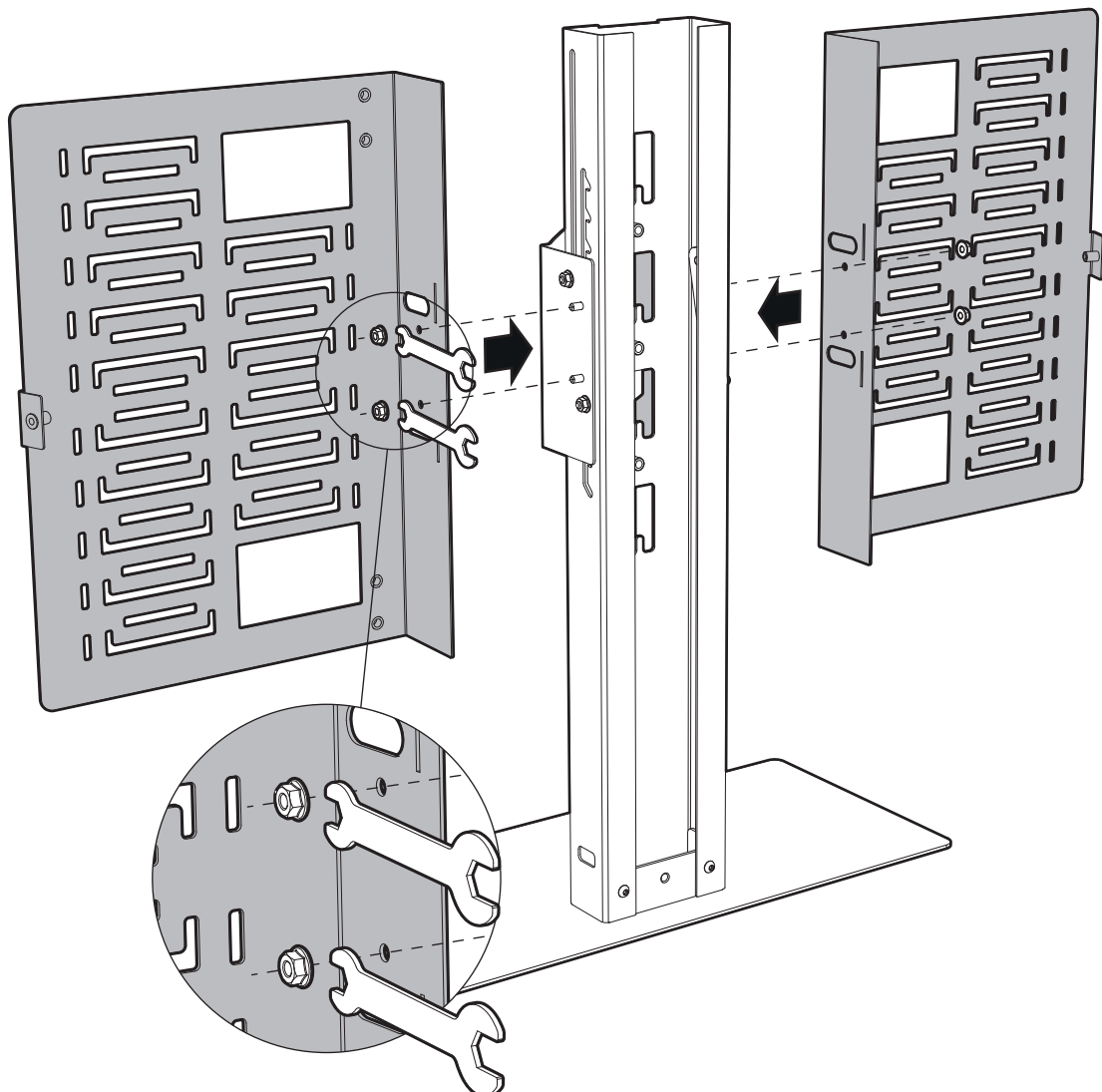

5

Ⓔ x2 + Ⓕ

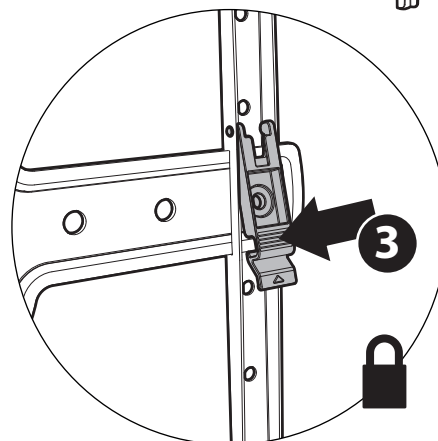
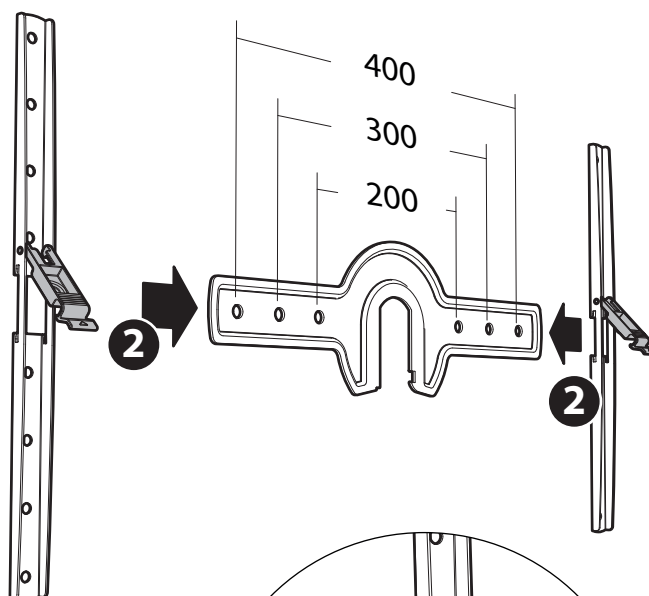
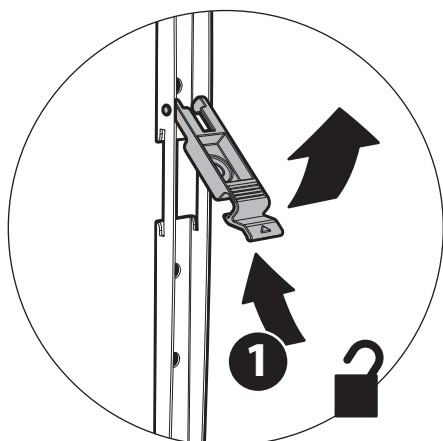

6

SCREEN SCREWS

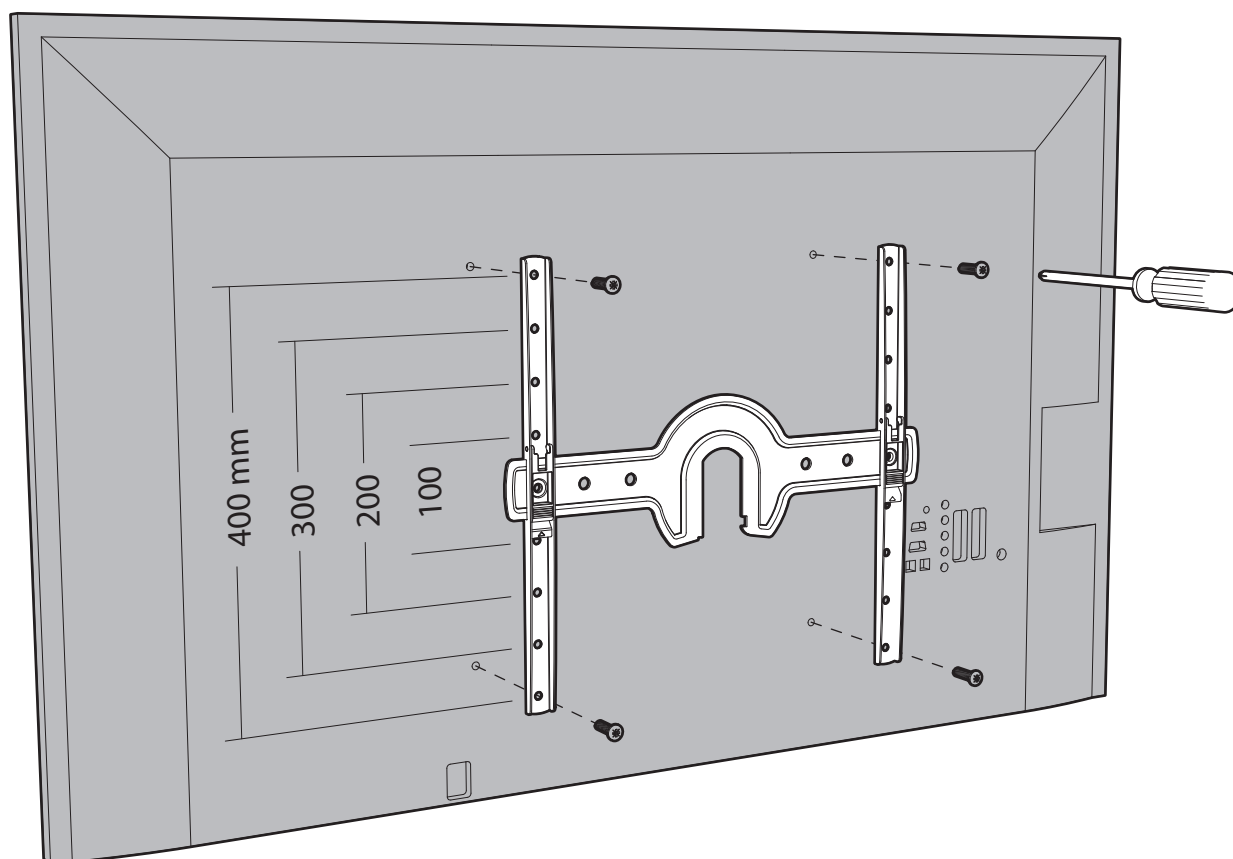

7

3

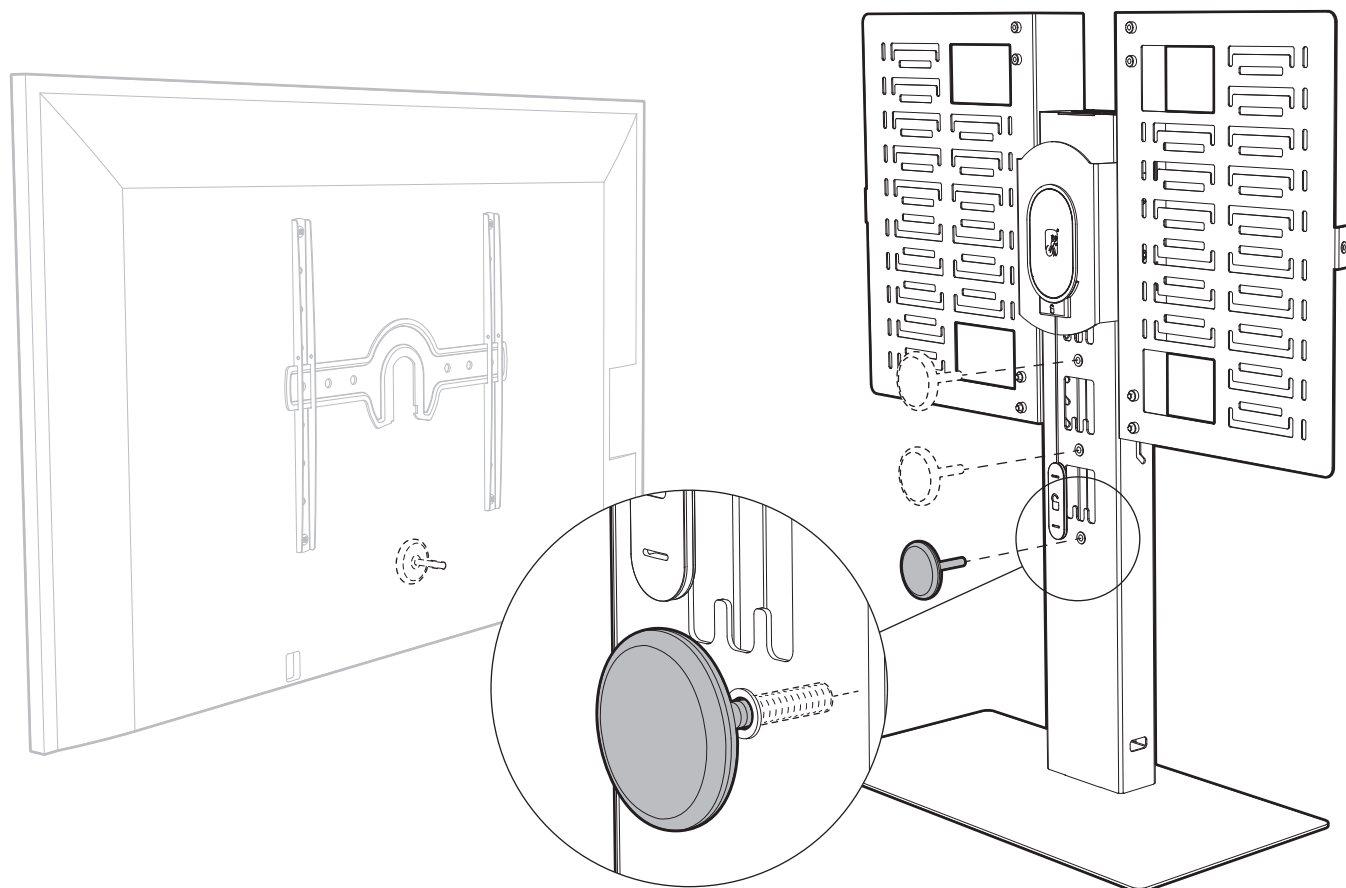

8

G x2 + H

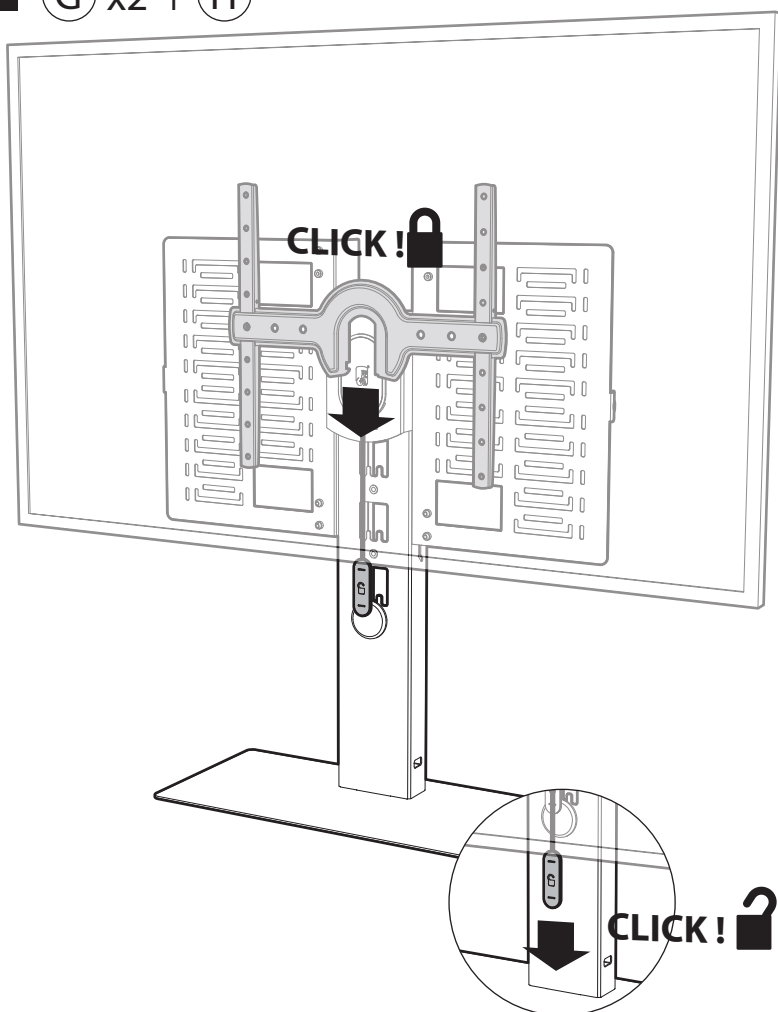

Optional step

1

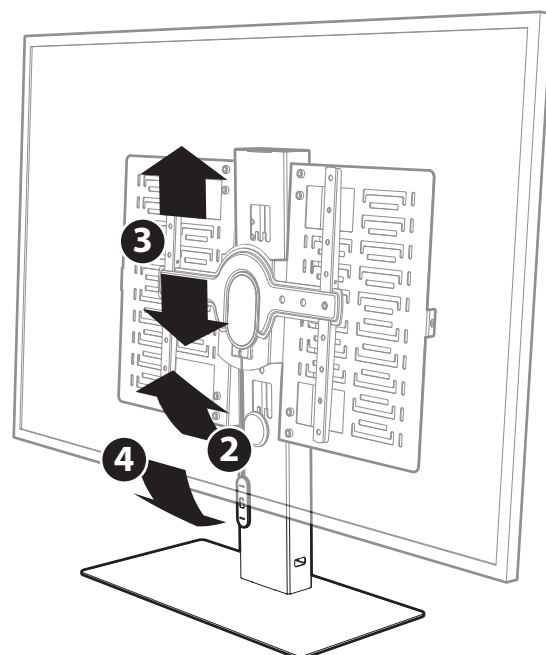
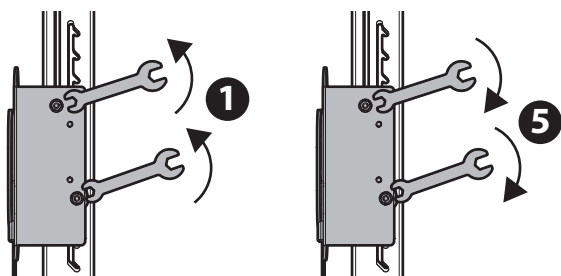

9

3

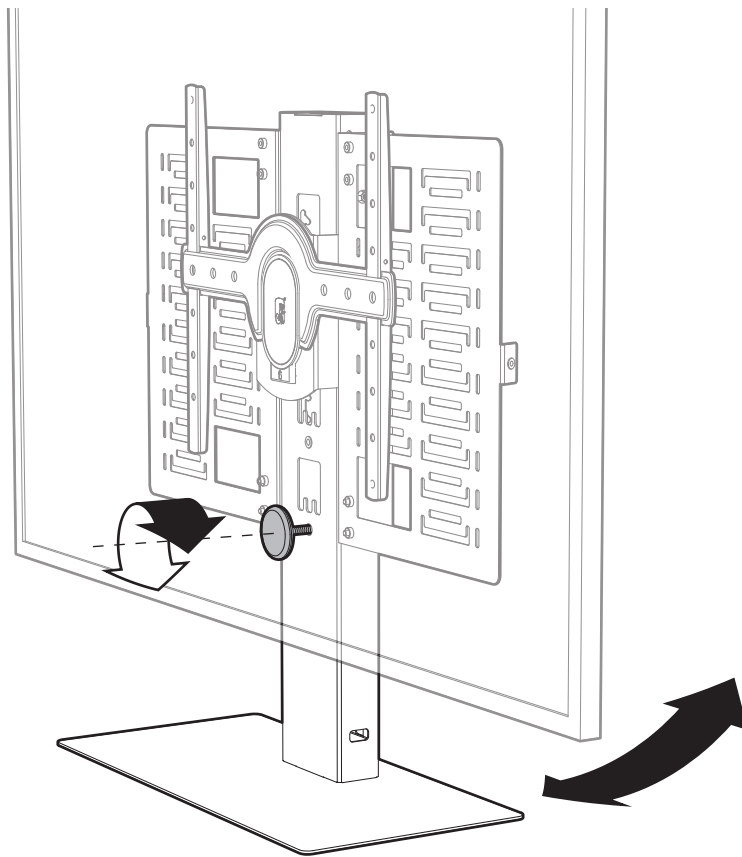

10

E + 5 x4 + 2

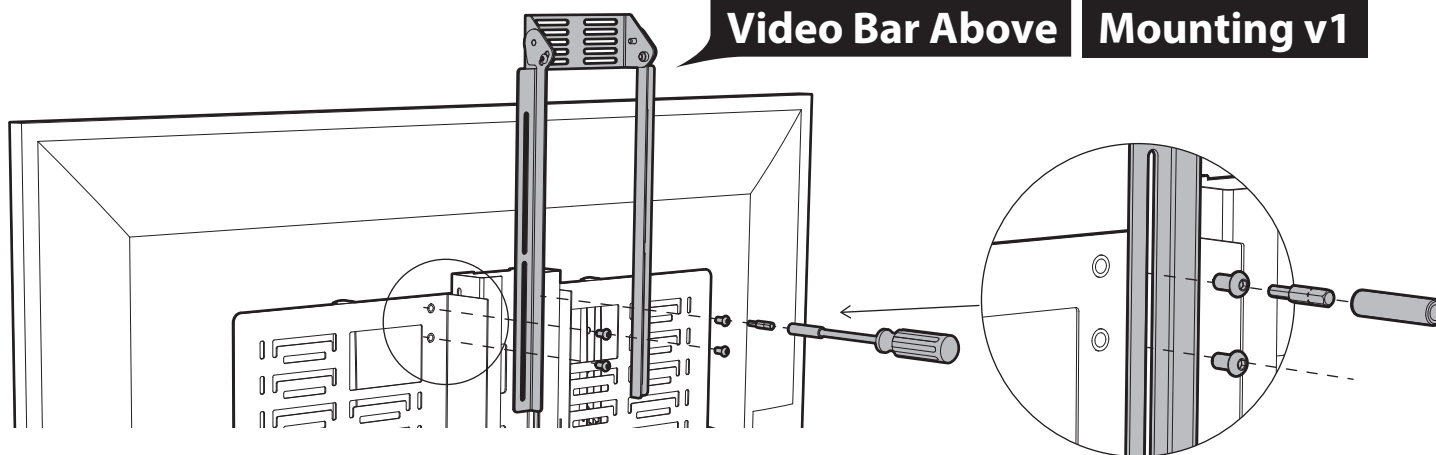
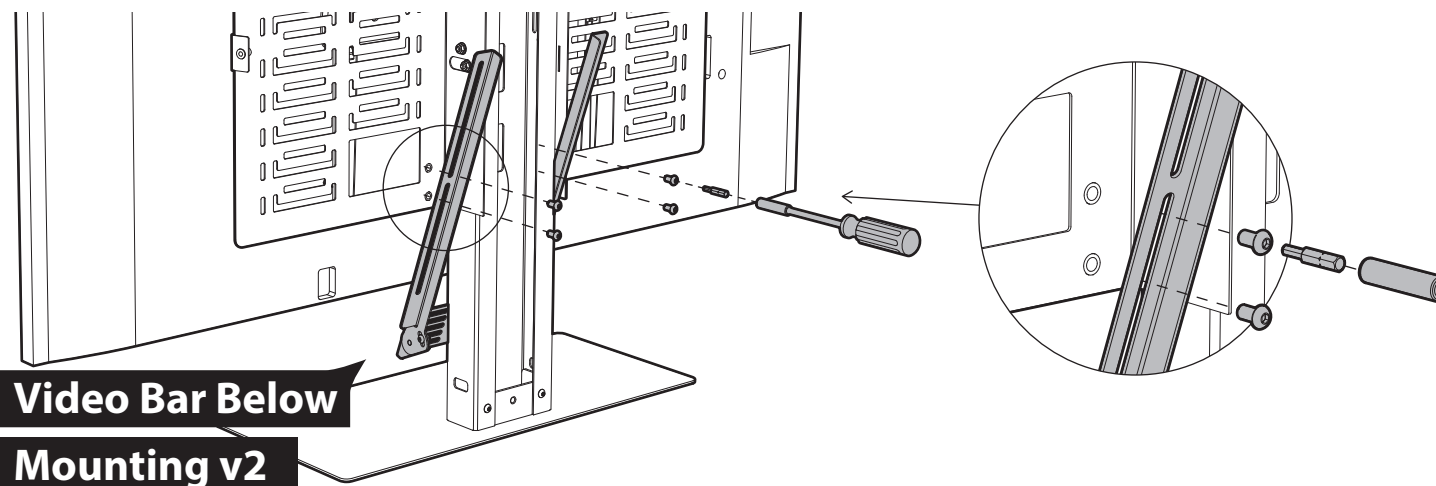
Video Bar Above Mounting v1

Video Bar Below Mounting v2

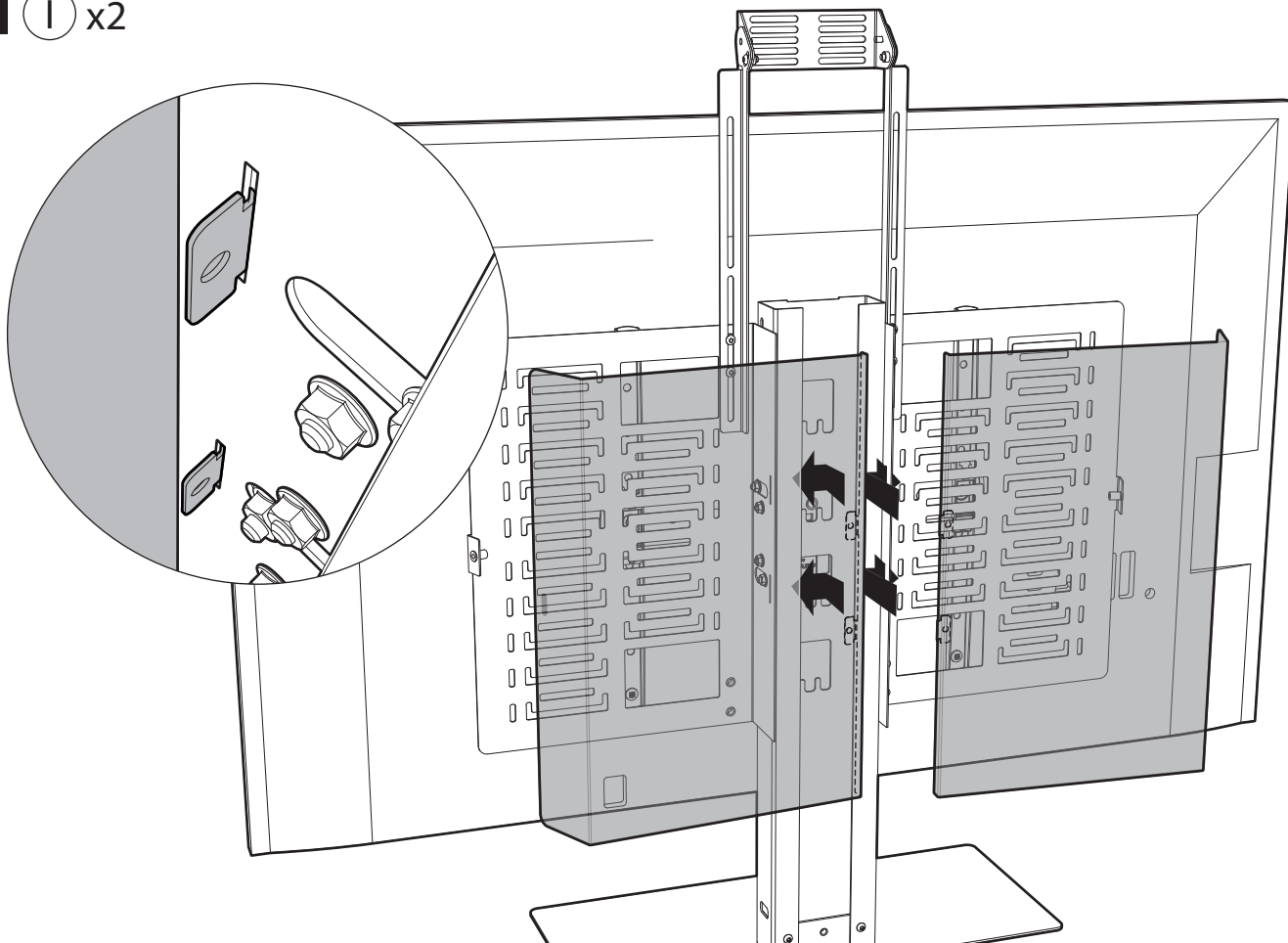
11 ① x2

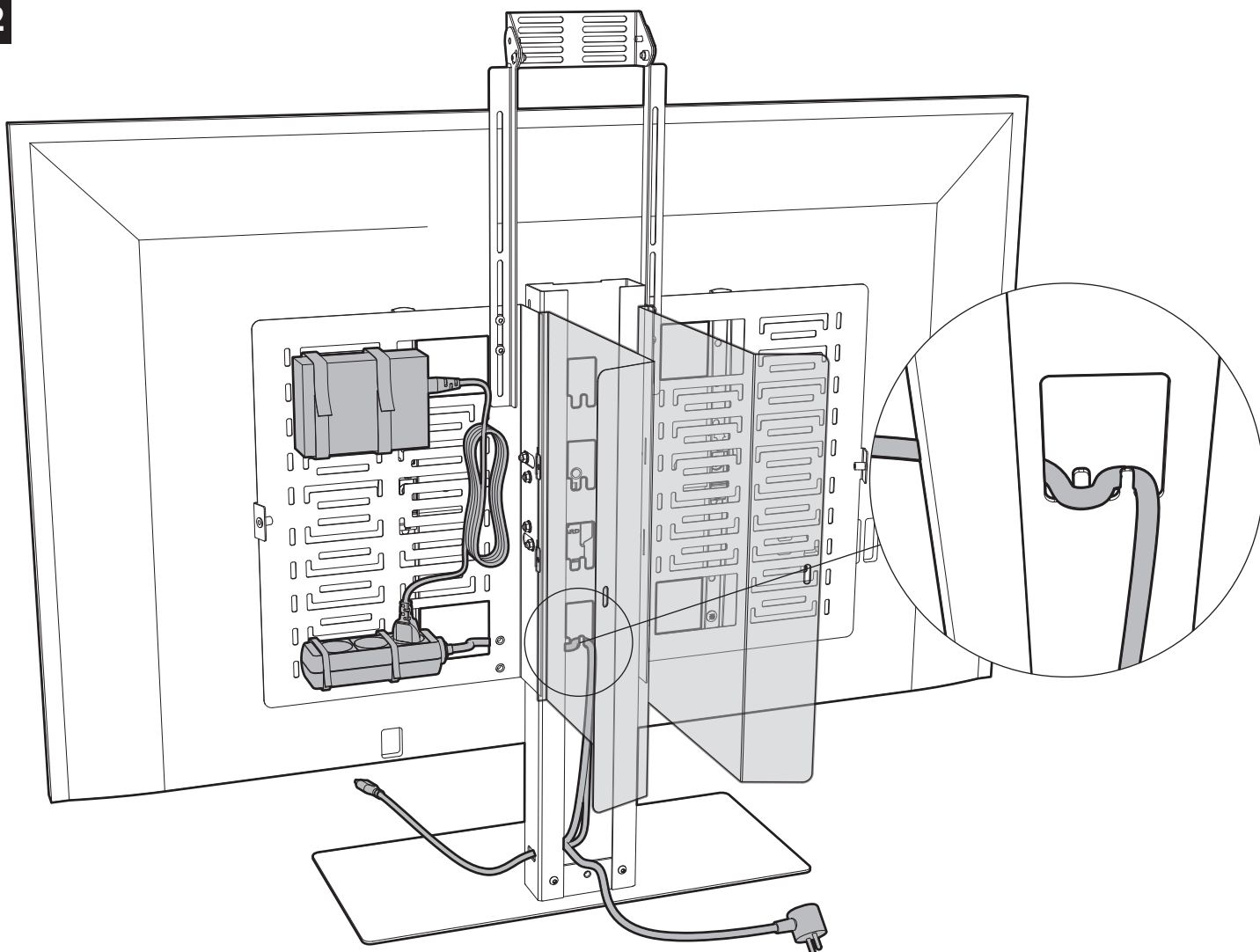

12



13 Mounting v1**13 Mounting v2****(F) + (1) + (6) x2**

(VIDEO BAR screws are not included)

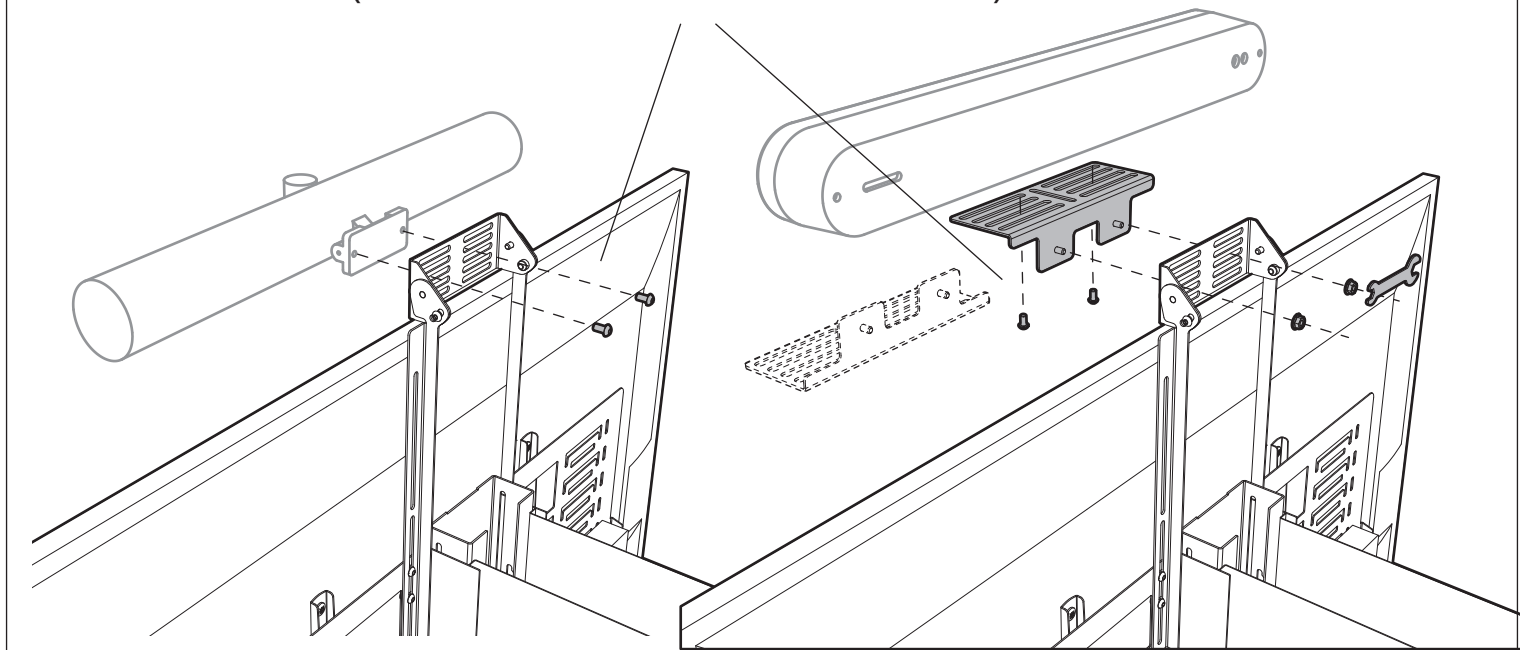
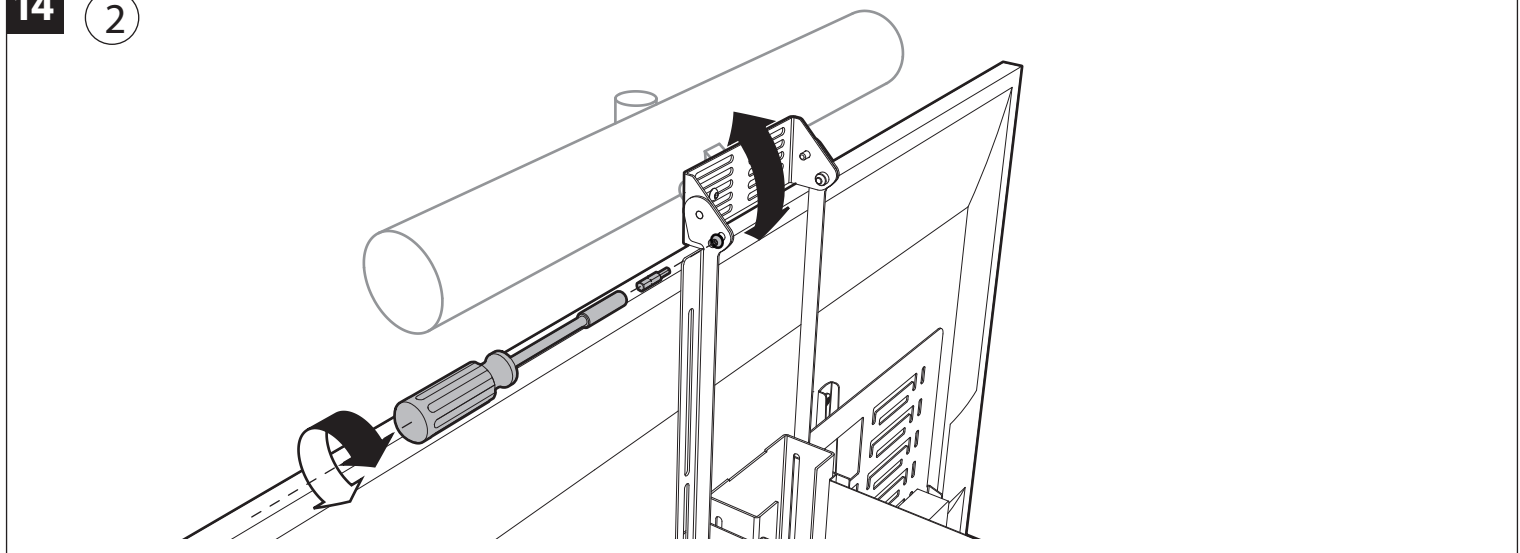
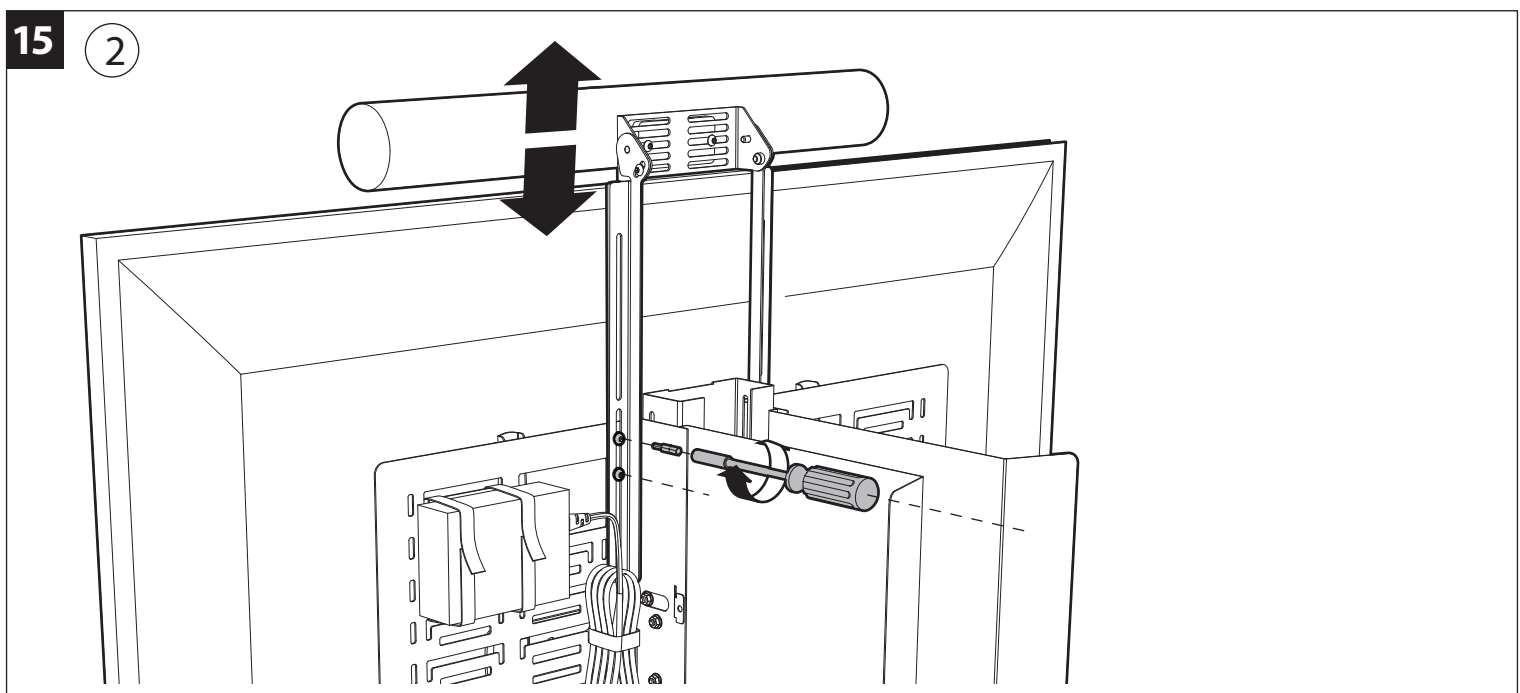
**14 (2)****15 (2)**

16 (2) + (5) x3

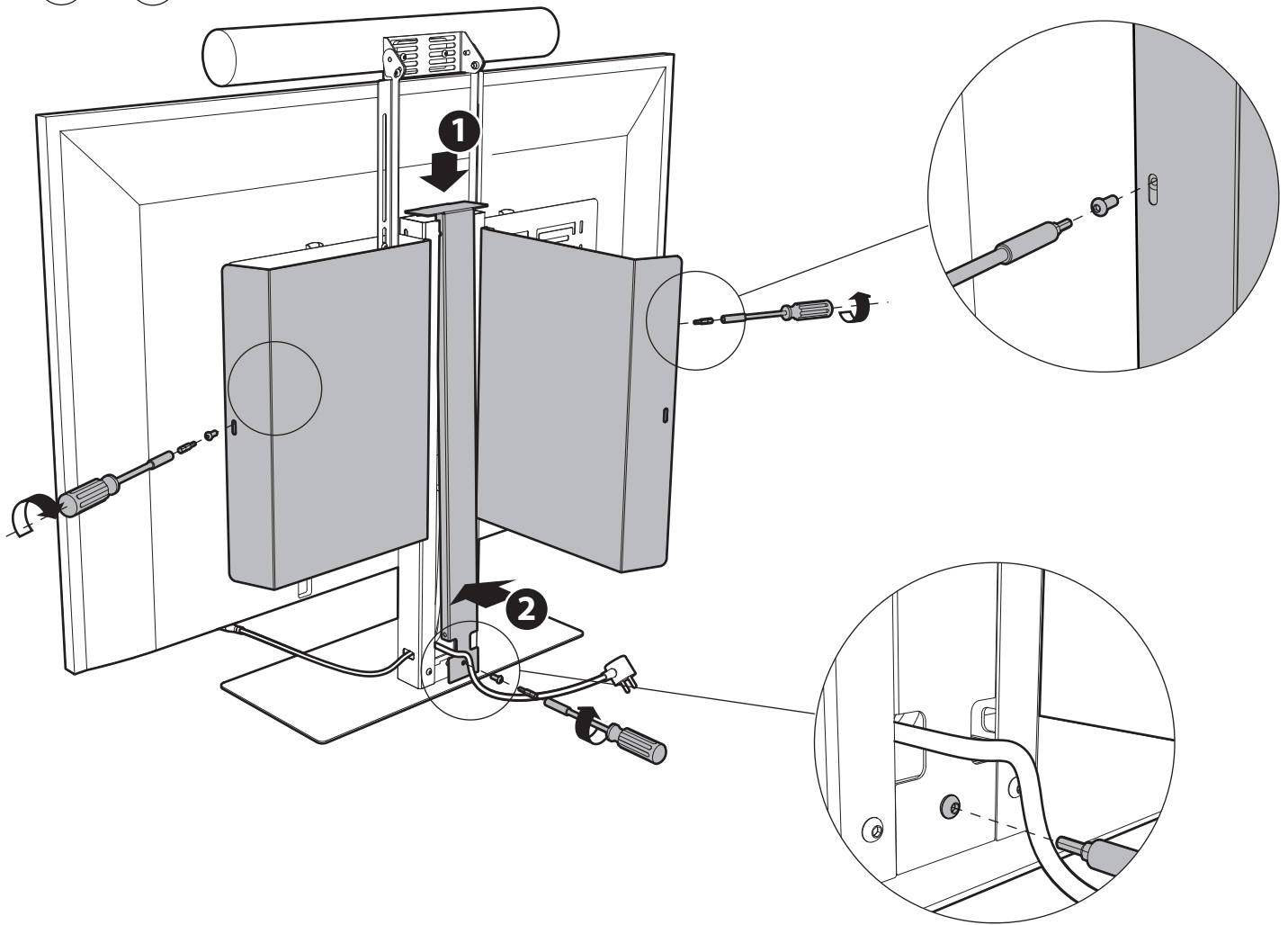

LIMITED WARRANTY

For three full years Salamander Designs Ltd will repair or replace, at our option, any product defective in materials or craftsmanship. Salamander Designs Ltd. will not be responsible for any damage to or destruction of other equipment consequential to our equipment failure. Defective product must be given Return Authorization and is to be returned to the factory prepaid, in the original carton and packing material. Any damage incurred in a shipment not in original packaging shall be the responsibility of the owner. Warranty repairs will be returned prepaid, via UPS within the continental U.S.A. only.

WWW.SALAMANDERCOMMERCIAL.COM

custom@salamanderdesigns.com

