

WindFall® Wall MOUNT

Assembly & Installation

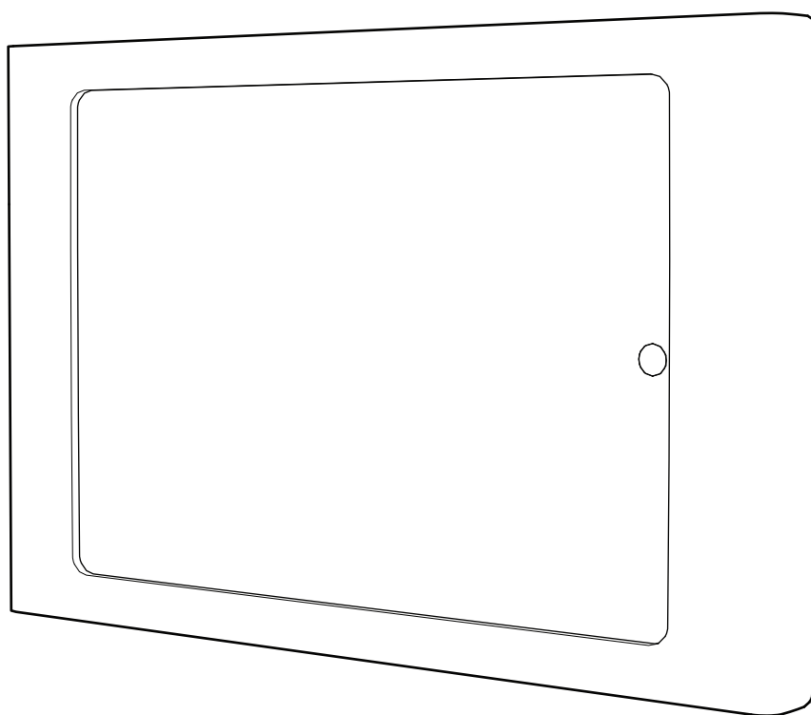

1:1

1x



Bezel assembly tool
F594

4x

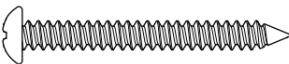

Drywall Mounting Screws
F360

4x

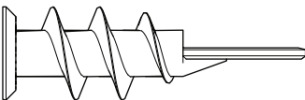

Drywall Mounting Mollies
F155

1 Remove front bezel

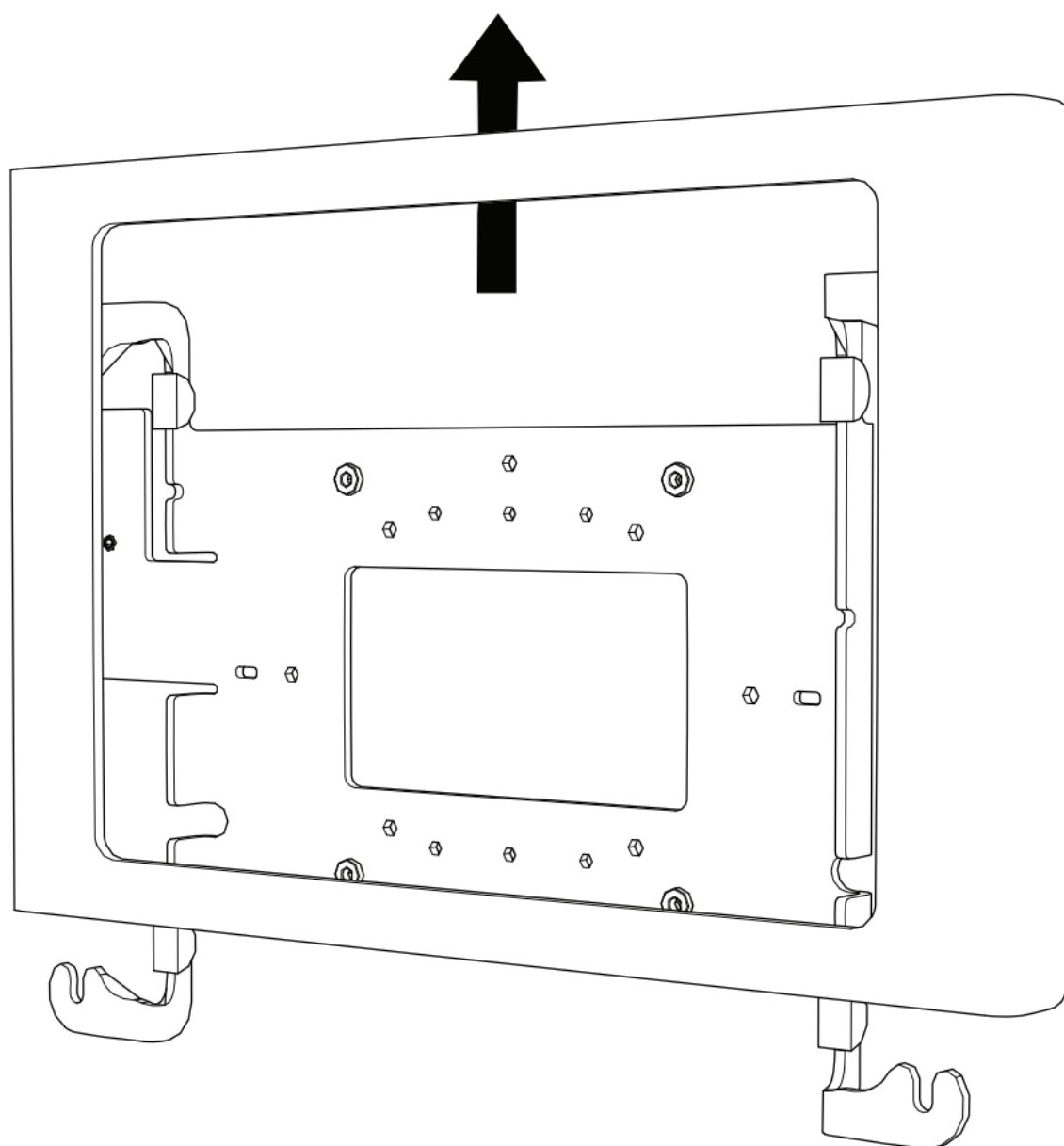

Option A - Drywall Mounting

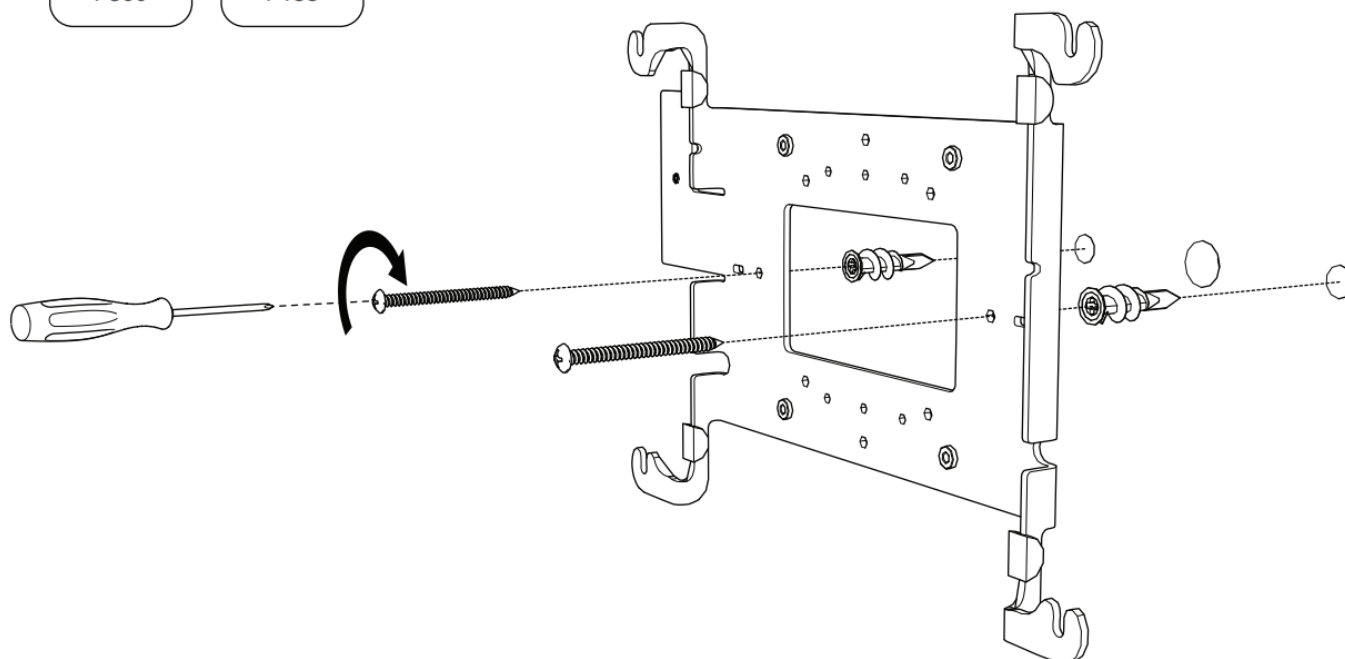
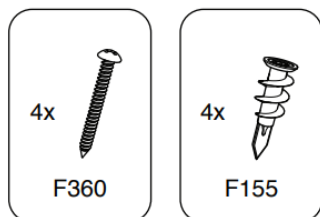

Option B - Gangbox

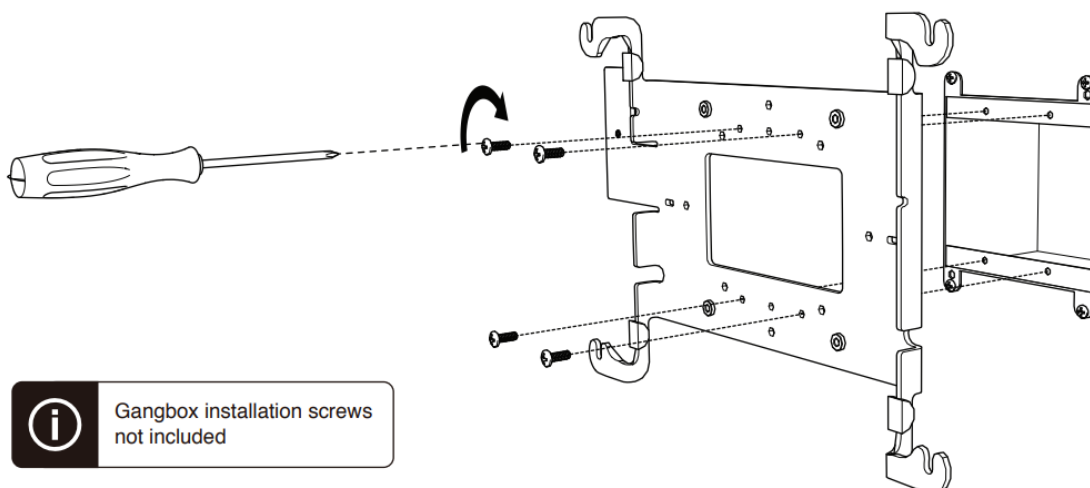

Option C - VESA arm (not included)

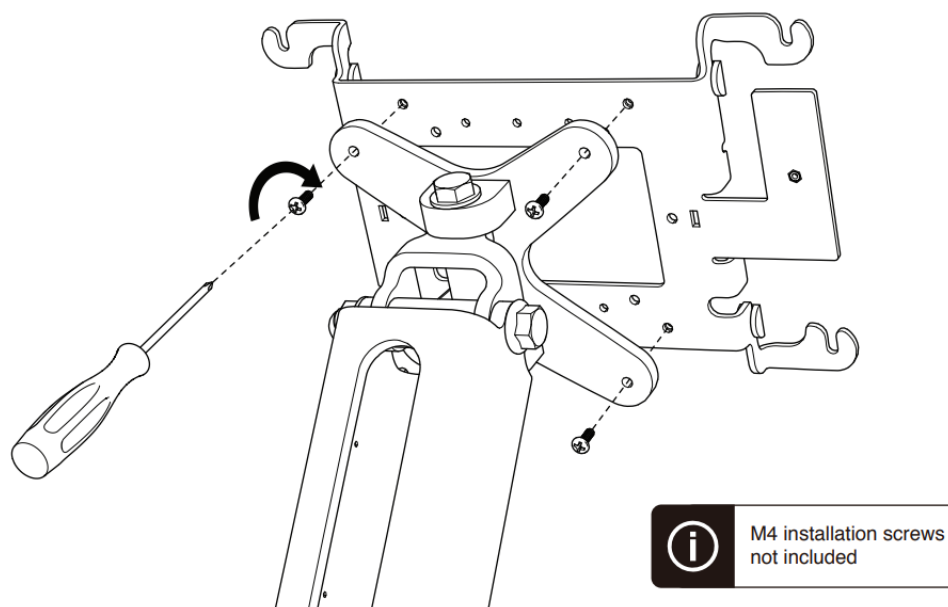

Option D - Kiosk Floor Stand (sold separately)

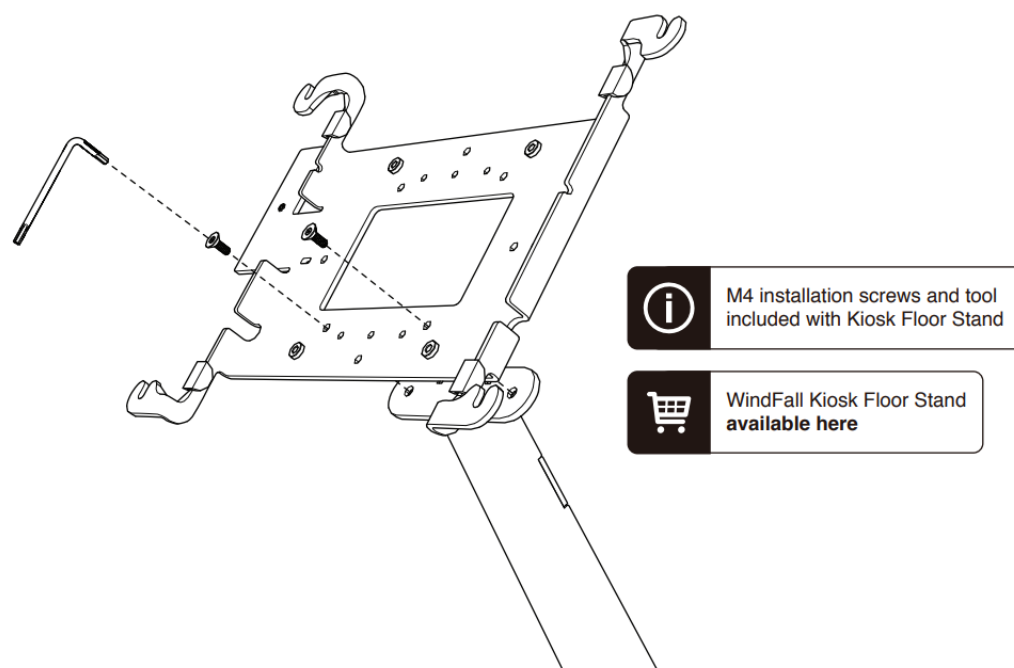

3 Optional: Install Power Over Ethernet (sold separately)



Installation tool included with
PoE Splitter with Lightning Cable



PoE Splitter with Lightning Cable
available here

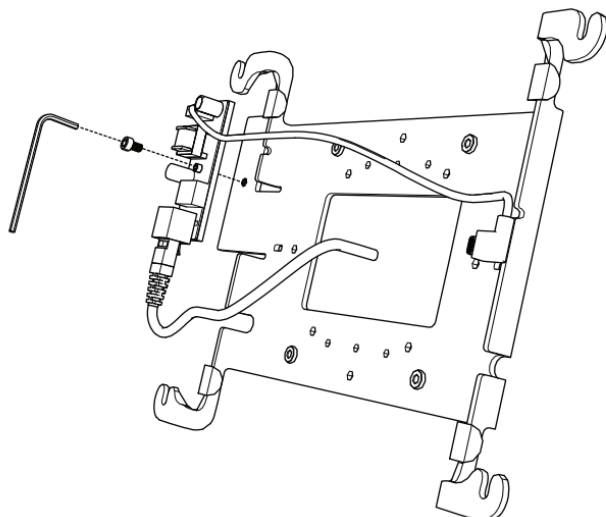

4 Install tablet, connect to power

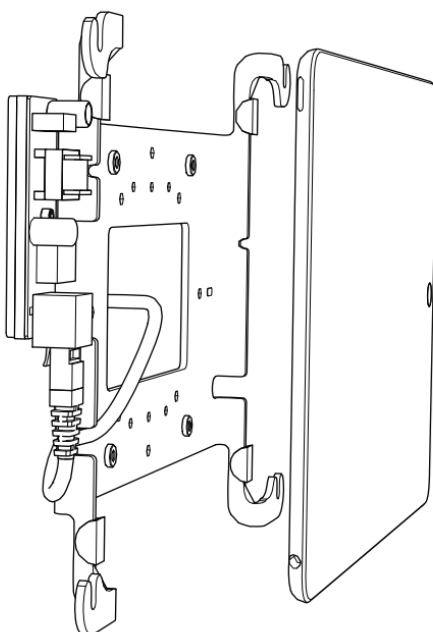

5 Install bezel

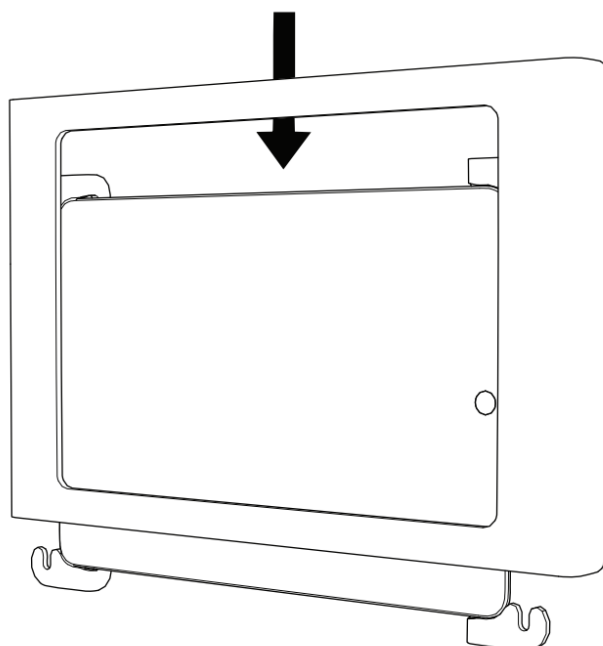

6 Tighten screws

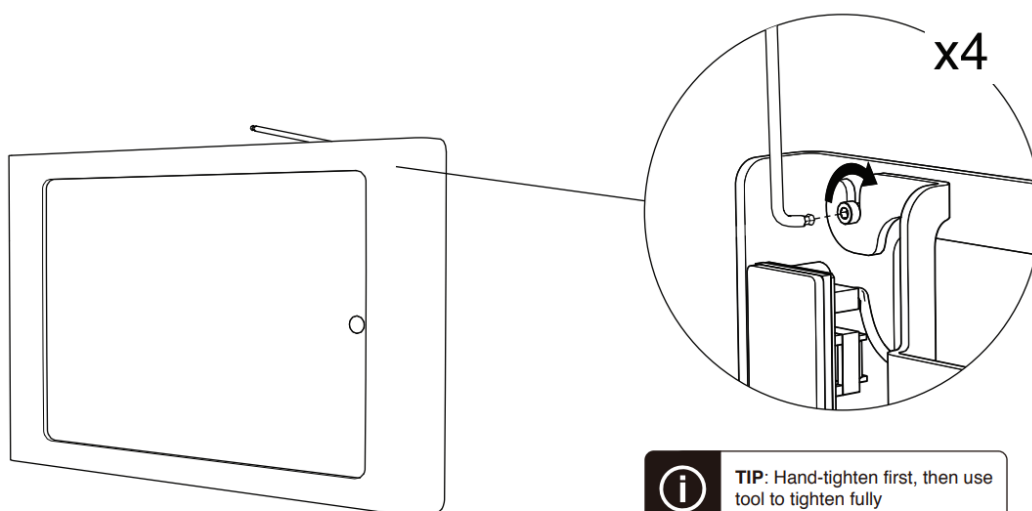

i **TIP:** Hand-tighten first, then use tool to tighten fully